

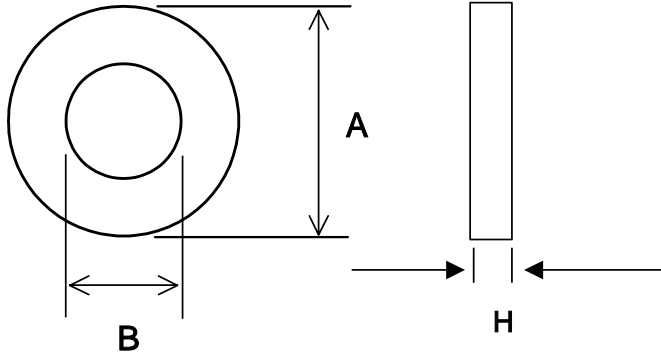

# TAPE WOUND CORES

# SYEC CORE



A: OUTER METER  
B: INNER DIAMETER  
H: HIGHT

TOLERANCE  $\pm 0.05$

## THE RANGE OF SIZE FOR TAPE WOUND CORE

THICKNESS	CORE SIZE(mm)		
	O.D	I.D	H
0.07T	15	10.0	5
0.1T	15	10.0	5
0.15T,0.2T	15	12.5	5

## AC MAGNETIC SPECIFICATION

Permeability	PC NI(80%) 0.07T	PC NI(80%)0.1T	PC NI(80%) 0.15T	PC NI(80%) 0.2T
TEST FREQUENCY(Hz)	60			
40 Gauss (4mT)	90,000 min	80,000 min	55,000 min	55,000 min
200 Gauss (20mT)	110,000 min	95,000 min	75,000 min	75,000 min
2,000 Gauss (0.2T)	200,000 min	160,000 min	115,000 min	115,000 min
0.4 A/m	100,000 min	100,000 min	60,000 min	60,000 min

We are able to supply you with various sizes and specificarions as per customer's demands.