

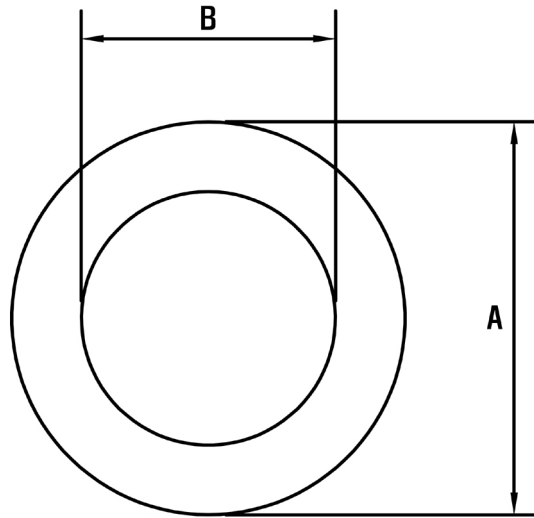

## CORES OF ZERO - CURREN - TRANSFORMER ( $\Phi 17.8$ , $\Phi 13.35$ , $\Phi 13.0$ , $\Phi 12.2$ )



TOLERANCE  $\pm 0.05\text{mm}$

### RING CORE STANDARD SIZE

TYPE	CORE SIZE(mm)		
	A	B	THICKNESS
$\Phi 17.8$	17.8	13.35	0.35
$\Phi 13.35$	13.35	9.85	0.35
$\Phi 13.0$	13.0	9.3	0.345
$\Phi 12.2$	12.0	8.8	0.345

### OUTPUT VOLTAGE CHARACTERISTICS

TYPE	SHEET	f	$I_1$	$N_1$	$N_2$	$R_L$	$V_o$
$\Phi 17.8$	5PCS	60Hz	20mA	1TURN	$\Phi 0.1 \times 950$ Turns	820	12.9mV MIN
$\Phi 13.35$	4PCS	60Hz	20mA	1TURN	$\Phi 0.09 \times 950$ Turns	820	12.8mV MIN
$\Phi 13.0, \Phi 12.2$	5PCS	60Hz	20mA	1TURN	$\Phi 0.1 \times 1000$ Turns	1KHz	17.0mV MIN

